

© CROWN COPYRIGHT AND DATABASE RIGHTS 2020
ORDNANCE SURVEY 100019180

PLAN

SCALE 1:500

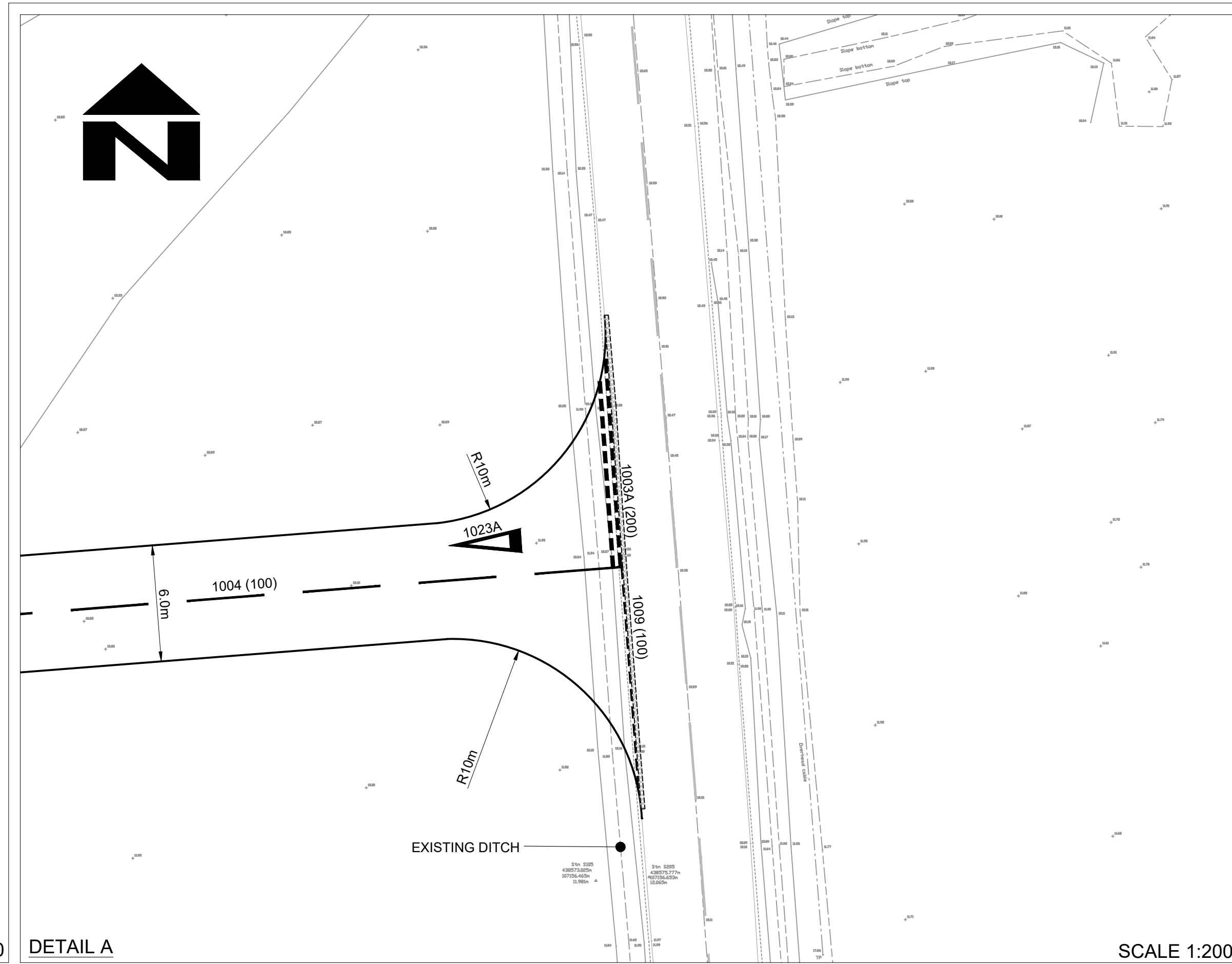
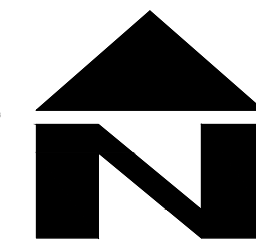

DETAIL A

SCALE 1:200

NOTES

1. DO NOT SCALE FROM THIS DRAWING.
2. ALL DIMENSIONS IN METRES UNLESS OTHERWISE STATED.
3. BELLMOUTH RADII TO BE 10m.
4. FOR DETAILS OF PROPOSED ROAD SIGNS SEE DRAWING No. CJ008720-ECH-GEN-00007777-DR-HE-1201

KEY

- PROPOSED CARRIAGEWAY - SEE APPENDIX 7.1.
- INLAY THE RECOVERED FOREST TURF ON THE EXISTING EXCAVATED CARRIAGEWAY AREA
- INLAY SURFACE COURSE 40mm AT NEW JUNCTION TIE-IN
- EXISTING HIGH FRICTION SURFACING
- PROPOSED KERB FOR DETAILS SEE HCC STANDARD DETAIL HCC10/C/010
- ROAD MARKING DIAG No. (WIDTH IN mm)

SUIT	REV	AMENDMENTS	DATE	CAD	CHKD	APPD

CLIENT
HAMPSHIRE COUNTY COUNCIL
ECONOMY, TRANSPORT AND ENVIRONMENT DEPARTMENT
STRATEGIC TRANSPORT

CONSULTANT

STUART JARVIS BSc DipTP FCIHT MRTPI: DIRECTOR OF ECONOMY, TRANSPORT & ENVIRONMENT

DESIGNER SS	SCALE @ A1 AS SHOWN	SCHEME IPLEY CROSS BEAULIEU SAFETY IMPROVEMENTS JOB No. C.J008720.01	DRAWING TITLE GENERAL ARRANGEMENT
CAD RB	DATE APRIL 2020		
CHECKED JW JW	SHEET NUMBER 1 OF 1	HCC CAD PLOT: 02/7/2020 16:20:57	SUIT REV D2 P01
APPROVED WW <i>ww</i>	DRAWING NUMBER CJ008720-ECH-HGN-00007777-DR-HE-0101		